

# De Grey Mining (DEG AU)

16 April 2020

**Ticker:** DEG.AX

**Net cash:** (~A\$9m)

**Project:** Hemi

**Market cap:** A\$338m

**Price:** A\$0.29/sh

**Country:** WA, Australia

**RECOMMENDATION:** NOT RATED / COVERED

We think drilling on the new Hemi discovery has already ‘de-risked’ an SCPe 2Moz @ 1.8g/t with a low strip to just 200m depth, which should likely support a reserve of ~1Moz at higher-grades, depending on dilution and grade-tonnage curves. Upcoming deep drilling to ~400m deep is critical, as a simple vertical endowment calculation indicates a potential 400koz / 50m vertical, demonstrating good upside potential. There is 325koz of mining inventory already defined from the first 1Moz of regional gold, and +1.2Moz defined since (for 2.2Moz existing regional gold on the 100% owned, 1500km<sup>2</sup> land package). Thus, we now see De Grey shaping up as a potential long-life ≥150koz pa open pit producer, a rare beast, all the more given its location in premium-geography, Australia. Next steps will be key as deep drilling serves to de-risk further ounces, but also provide feed for metallurgical samples, with many nearby assets being refractory. On a hub-and-spoke model, we see potential for >4Moz group resources by year-end, with the potential for 1.5Moz of those, including satellites, to make profitable reserves.

## SCP RADAR: Hemi – a game changer for De Grey with SCPe 2Moz @ 1.8g/t already drilled

De Grey has been exploring their >1,500km<sup>2</sup> Pilbara licence, itself only 60km from Port Hedland in Western Australia, since 2016. An early 3Q17 1.0Moz @ 1.7g/t resource provided a mining inventory of 325koz @ 2.1g/t. Drilling known targets in 2018 and 2019 lifted the global resource to the current 2.2Moz @ 1.8g/t, which would be reasonably expected to drive a larger reserve base. However, the watershed moment came after a 2H19 move to greenfields target Hemi. Shallow air-core results of 43m @ 3.7g/t and 25m @ 2.7g/t on **Aquila** and **Brolga** failed to grab ECM attention at first, as the market cap lifted by ~A\$10m to A\$50m. However, subsequent RC and diamond drilling highlights of **97m @ 3.2g/t** and **78m @ 1.8g/t** lifted enthusiasm, with the stock ~quadrupling to A\$200m in 1Q20, and now at A\$338m as deep drilling results are awaited. The discovery lies under ~30m cover, and is concentrated in two zones parallel to a regional NE-SW shear zone. Mineralization is associated with pyrite and arsenopyrite, and the preferred host is fractured and hydrothermally altered pipe-shaped intrusions.

**Figure 1. Plan map of regional holding (inset) including Hemi area on the east of the licences**

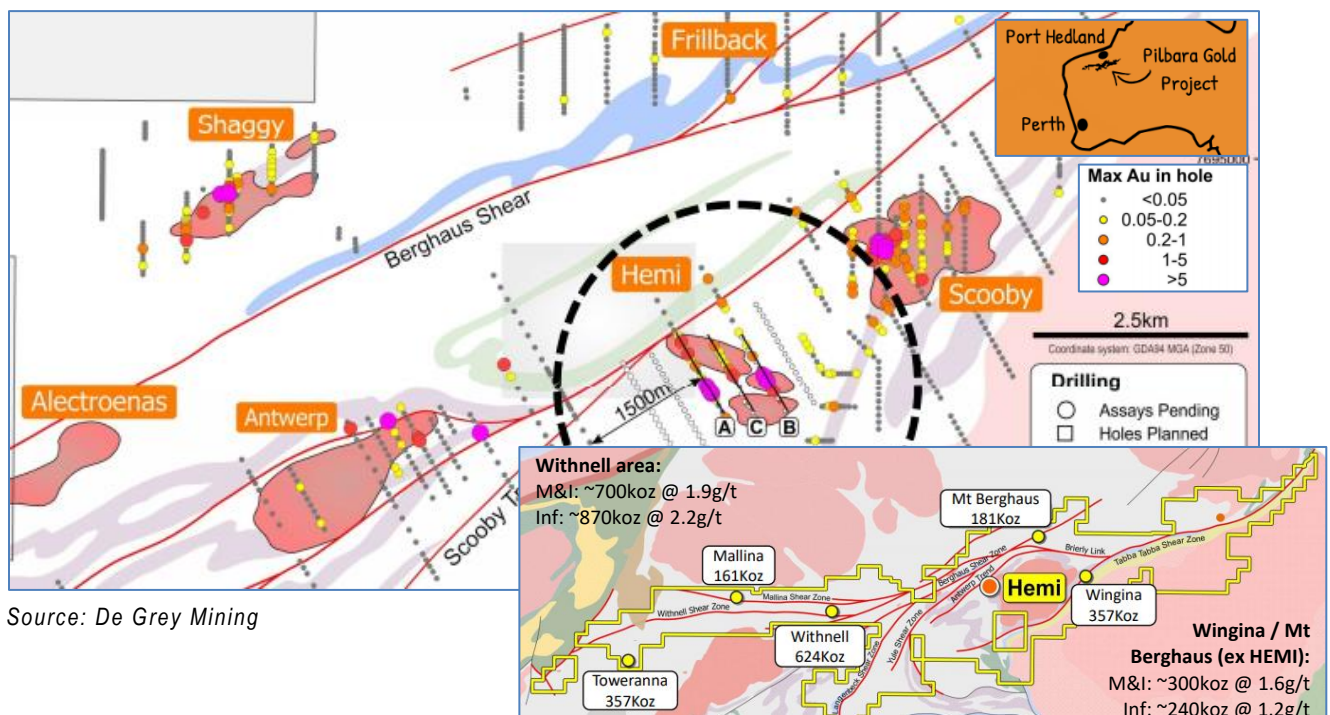

Source: De Grey Mining

# Equity Research

Drilling to date has defined several moderately dipping, well-mineralised ore lodes at Brolga centered over an oblate intrusion approximately 300m in diameter (Figure 1). The less well-defined Aquila system appears to lie in a discrete intrusion, centred on a more steeply dipping NE-SW shear zone.

Figure 2: (A) Aquila and Brolga plan; (B) Aquila section – 5 March (C) Brolga section – 17 March

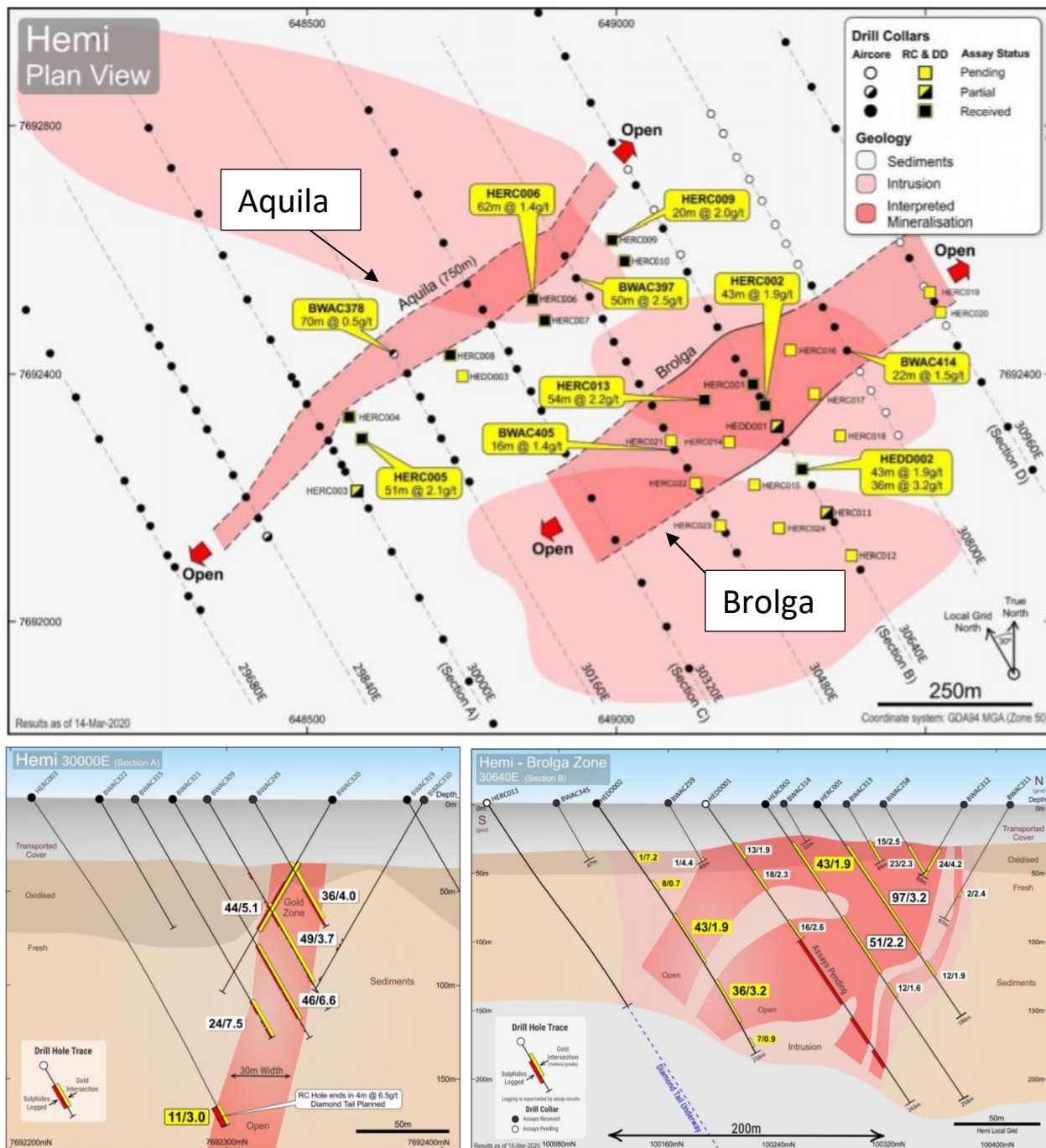



# Equity Research

---

## Plenty of growth beyond initial estimates: SCPe +400koz / 50m vertical

Drilling will continue at both Aquila and Brolga to define the limits of mineralisation, with infill to increase resource confidence. First pass will be at 80x80m to 400m below surface. Early indications from initial deep diamond drilling at Brolga show strong sulfide contents, which correlate well with gold abundance. Ounce growth will necessarily slow as holes deepen, and move to RC with diamond tails. Although we don't expect deep drilling to materially contribute to maiden resources tentatively scheduled for 3Q20, results dependent, it could add materially thereafter. Simplistically, every additional 50m of depth extent De Grey can define at similar thickness and grade to Brolga could add up to 400koz of additional mineral inventory. Based on this, initial deep drilling will be a material catalyst given the ability of investors to assess potential resource growth. Other deposits within the Mallina project show a mix of free milling and non-free milling ore that the company has been developing a process flow sheet to accommodate. We think this flowsheet will now be driven by Hemi and expect near term metallurgical information to further de-risk the project.

## Hemi: central hub to maximise value from nearby satellite deposits across the Mallina project

A 2Q20 update saw licence-wide resources (ie ex Hemi) lift to 2.2Moz @ 1.8g/t. This is spread over ~80km and five discrete zones ranging from 180-600koz. The various deposits are a mix of free milling (e.g. Towerana) and refractory (e.g. Withnall) ore types. Whilst this will certainly not contribute multi-million ounces of reserves trucking to Hemi, in our view we should see a material regional contribution. Hemi's central location and dominant endowment provides a natural hub from which to reevaluate these discrete resources as value adding satellites where appropriate (Figure 1).

## 'Hemi-style' now acts as blueprint for regional exploration

Regionally, Mallina project looks prospective for the discovery of additional "Hemi-style" systems under shallow cover, with a number of analogous structural settings and inferred intrusions already identified for first pass follow up with supporting first pass geochemistry. These include Scooby, Shaggy and Antwerp (Figure 1) all adjacent to Hemi. The style of mineralisation at Hemi shares elements of both intrusion related gold systems (IRGS) and orogenic lode gold deposits and in many respects has no local analogues in Australia.

## Why we like De Grey Mining

1. Existing SCPe 2Moz 'de-risked' from drilling
2. Speculative potential to add 50-100% with depth continuity
3. Greenfields discovery meaning majors did not see the opportunity
4. Current data points to a large scale, low strip vanilla pit
5. Exploration upside from recognition of new deposit style, near-Hemi and regionally

## Catalysts

- 2Q20: Ongoing drill results from Aquila and Brolga with 3 rigs delineating the mineralisation.
- 3Q20: Maiden Hemi resource
- 2H20: Preliminary metallurgical data
- 2020: Testing new targets

## Brock Salier

Partner, Sprott Capital Partners  
T: +44.207.659.0841  
M: +44.7400.666.913  
[bsalier@sprott.com](mailto:bsalier@sprott.com)

## Chris Tonkin

Research Associate, Sprott Capital Partners  
T: +44.207.659.0841  
M: +44.7470.766.724  
[ctonkin@sprott.com](mailto:ctonkin@sprott.com)

## DISCLOSURES & DISCLAIMERS

This research report (as defined in IIROC Rule 3400) is issued and approved for distribution in Canada by Sprott Capital Partners LP ("SCP"), an investment dealer who is a member of the Investment Industry Regulatory Organization of Canada ("IIROC") and the Canadian Investor Protection Fund ("CIPF"). The general partner of SCP is Sprott Capital Partners GP Inc. and SCP is a wholly-owned subsidiary of Sprott Inc., which is a publicly listed company on the Toronto Stock Exchange under the symbol "SII". Sprott Asset Management LP ("SAM"), a registered investment manager to the Sprott Funds and is an affiliate of SCP. This research report is provided to retail clients and institutional investors for information purposes only. The opinions expressed in this report are the opinions of the author and readers should not assume they reflect the opinions or recommendations of SCP's research department. The information in this report is drawn from sources believed to be reliable but the accuracy or completeness of the information is not guaranteed, nor in providing it does SCP and/or affiliated companies or persons assume any responsibility or liability whatsoever. This report is not to be construed as an offer to sell or a solicitation of an offer to buy any securities. SCP accepts no liability whatsoever for any loss arising from any use or reliance on this research report or the information contained herein. Past performance is not a guarantee of future results, and no representation or warranty, expressed or implied, is made regarding future performance of any security mentioned in this research report. The price of the securities mentioned in this research report and the income they generate may fluctuate and/or be adversely affected by market factors or exchange rates, and investors may realize losses on investments in such securities, including the loss of investment principal. Furthermore, the securities discussed in this research report may not be liquid investments, may have a high level of volatility or may be subject to additional and special risks associated with securities and investments in emerging markets and/or foreign countries that may give rise to substantial risk and are not suitable for all investors. SCP may participate in an underwriting of, have a position in, or make a market in, the securities mentioned herein, including options, futures or other derivatives instruments thereon, and may, as a principal or agent, buy or sell such products.

**DISSEMINATION OF RESEARCH:** SCP's research is distributed electronically through email or available in hard copy upon request. Research is disseminated concurrently to a pre-determined list of clients provided by SCP's Institutional Sales Representative and retail Investment Advisors. Should you wish to no longer receive electronic communications from us, please contact [unsubscribe@sprott.com](mailto:unsubscribe@sprott.com) and indicate in the subject line your full name and/or corporate entity name and that you wish to unsubscribe from receiving research.

**RESEARCH ANALYST CERTIFICATION:** Each Research Analyst and/or Associate who is involved in the preparation of this research report hereby certifies that:

- The views and recommendations expressed herein accurately reflect his/her personal views about any and all of the securities or issuers that are the subject matter of this research report;
- His/her compensation is not and will not be directly related to the specific recommendations or view expressed by the Research analyst in this research report;
- They have not affected a trade in a security of any class of the issuer within the 30-day period prior to the publication of this research report;
- They have not distributed or discussed this Research Report to/with the issuer, investment banking group or any other third party except for the sole purpose of verifying factual information; and
- They are unaware of any other potential conflicts of interest.

**UK RESIDENTS:** Sprott Partners UK Limited ("Sprott") is an appointed representative of PillarFour Securities LLP which is authorized and regulated by the Financial Conduct Authority. This document has been approved under section 21(1) of the FMSA 2000 by PillarFour Securities LLP ("PillarFour") for communication only to eligible counterparties and professional clients as those terms are defined by the rules of the Financial Conduct Authority. Its contents are not directed at UK retail clients. PillarFour does not provide investment services to retail clients. PillarFour publishes this document as non-independent research which is a marketing communication under the Conduct of Business rules. It has not been prepared in accordance with the regulatory rules relating to independent research, nor is it subject to the prohibition on dealing ahead of the dissemination of investment research. It does not constitute a personal recommendation and does not constitute an offer or a solicitation to buy or sell any security. Sprott and PillarFour consider this note to be an acceptable minor non-monetary benefit as defined by the FCA which may be received without charge. This is because the content is either considered to be commissioned by Sprott's clients as part of their advisory services to them or is short term market commentary. Neither Sprott nor PillarFour nor any of its directors, officers, employees or agents shall have any liability, howsoever arising, for any error or incompleteness of fact or opinion in it or lack of care in its preparation or publication; provided that this shall not exclude liability to the extent that this is impermissible under the law relating to financial services. All statements and opinions are made as of the date on the face of this document and are not held out as applicable thereafter. This document is intended for distribution only in those jurisdictions where PillarFour is permitted to distribute its research.

**IMPORTANT DISCLOSURES FOR U.S. PERSONS:** This research report was prepared by Sprott Capital Partners LP ("SCP"), a company authorized to engage in securities activities in Canada. SCP is not a registered broker/dealer in the United States and, therefore, is not subject to U.S. rules regarding the preparation of research reports and the independence of research analysts. This research report is provided for distribution to "major U.S. institutional investors" in reliance on the exemption from registration provided by Rule 15a-6 of the U.S. Securities Exchange Act of 1934, as amended (the "Exchange Act"). Any U.S. recipient of this research report wishing to effect any transaction to buy or sell securities or related financial instruments based on the information provided in this research report should do so only through Sprott Global Resource Investments Ltd. ("SGRIL"), a broker dealer in the United States registered with the Securities Exchange Commission ("SEC"), the Financial Industry Authority ("FINRA"), and a member of the Securities Investor Protection Corporation ("SIPC"). Under no circumstances should any recipient of this research report effect any transaction to buy or sell securities or related financial instruments through SCP.

SGRIL accepts responsibility for the contents of this research report, subject to the terms set out below, to the extent that it is delivered to a U.S. person other than a major U.S. institutional investor. The analyst whose name appears in this research report is not licensed, registered, or qualified as a research analyst with FINRA and may not be an associated person of SGRIL and, therefore, may not be subject to applicable restrictions under FINRA Rule 2241 regarding communications by a research analyst with a subject company,

# Equity Research

public appearances by the research analyst, and trading securities held by a research analyst account. To make further inquiries related to this report, United States residents should contact their SGRIL representative.

**ANALYST CERTIFICATION / REGULATION AC:** The analyst and associate certify that the views expressed in this research report accurately reflect their personal views about the subject securities or issuers. In addition, the analyst and associate certify that no part of their compensation was, is, or will be directly or indirectly related to the specific recommendations or views expressed in this research report.

**SPROTT CAPITAL PARTNERS EXPLANATION OF RECOMMENDATIONS:** Should SCP issue research with recommendations, the research rating guidelines will be based on the following recommendations:

**BUY:** The stocks total returns are expected to be materially better than the overall market with higher return expectations needed for more risky securities markets

**NEUTRAL:** The stock's total returns are expected to be in line with the overall market

**SELL:** The stocks total returns are expected to be materially lower than the overall market

**TENDER:** The analyst recommends tendering shares to a formal tender offering

**UNDER REVIEW:** The stock will be placed under review when there is a significant material event with further information pending; and/or when the research analyst determines it is necessary to await adequate information that could potentially lead to a re-evaluation of the rating, target price or forecast; and/or when coverage of a particular security is transferred from one analyst to another to give the new analyst time to reconfirm the rating, target price or forecast.

**NOT RATED ((N/R):** The stock is not currently rated

Research Disclosure		Response
1	SCP and its affiliates collectively beneficially owns 1% or more of any class of the issuer's equity securities <sup>1</sup>	NO
2	The analyst or any associate of the analyst responsible for the report or recommendation or any individual directly involved in the preparation of the report holds or is short any of the issuer's securities directly or through derivatives	NO
3	An SCP partner, director, officer or analyst involved in the preparation of a report on the issuer, has during the preceding 12 months provided services to the issuer for remuneration other than normal course investment advisory or trading execution services	NO
4	SCP has provided investment banking services for the issuer during the 12 months preceding the date of issuance of the research report or recommendation	NO
5	Name of any director, officer, employee or agent of SCP who is an officer, director or employee of the issuer, or who serves in an advisory capacity to the issuer	NO
6	SCP is making a market in an equity or equity related security of the issuer	NO
7	The analyst preparing this report received compensation based upon SCP's investment banking revenue for the issuer	NO
8	The analyst has conducted a site visit and has viewed a major facility or operation of the issuer	YES
9	The analyst has been reimbursed for travel expenses for a site visit by the issuer	NO

## Sprott Capital Partners Equity Research Ratings:

Summary of Recommendations as of April 2020	
BUY:	12
HOLD:	0
SELL:	0
UNDER REVIEW:	0
TENDER:	2
NOT RATED:	1
<b>TOTAL</b>	<b>15</b>

<sup>1</sup> As at the end of the month immediately preceding the date of issuance of the research report or the end of the second most recent month if the issue date is less than 10 calendar days after the end of the most recent month